



## 1CH H.264 Real-time Network Video Encoder

### Key Features

- Full frame H.264 transmission
- H.264 and JPEG triple encoding: A total of 3 outputs, comprising of 2 H.264 outputs and 1 JPEG output, can be provided.
- Motion adaptive interlace/progressive conversion allows every frame to be clear even when the subject is moving.
- Open command conversion table for RS485 ensures the control of various manufacture's PTZ camera.
- Camera title display: Up to 20 alphanumeric characters embedded in the image
- PoE. The power will be supplied by simply connecting a LAN cable. (IEEE802.3af compliant) 12 V DC power supply\* is also available.
- Small size. And can be installed into the outdoor housing with a camera.
- Alarm sources including VMD, Command alarm, and Video loss
- VMD (Video Motion Detector) with 4 programmable detection areas
- Internet mode: H.264 images can be transmitted by over HTTP protocol.
- Multi-language GUI and setup menu: English, French, Italian, Spanish, German, Russian, Chinese, Japanese

- IPv4/IPv6 protocol supported

- Onvif compliant model

\* For UL listed model(s), only connect 12 V DC Class 2 power supply.

### Standard Accessories

• Installation Guide.....	1 pc.
• CD-ROM*1 .....	1 pc.
• Code label*2.....	1 pc.
• Power cord plug.....	1 pc.
• Cable tie .....	2 pcs. (incl. 1 spare)

\*1 The CD-ROM contains the operating instructions and different kinds of tool software programs.  
\*2 This label may be required for network management. The network administrator shall retain the code label.

## Specifications

TV System		NTSC	PAL	
<b>Video IF</b>	Video Input Connector	1 V [p-p]/75 Ω, NTSC or PAL composite video signal* * NTSC and PAL can be switched in the setup menu.		
<b>Browser GUI</b>	Camera Control	pan / tilt / zoom / focus / preset positions / auto focus / brightness		
	Camera Control Protocol	Panasonic/Pelco-D/Pelco-P/Custom		
	Display Mode	Up to 16 camera images can be displayed simultaneously on a multi-screen. (Including the camera itself)		
	Unit Title	Up to 20 characters		
	Camera Title (OSD)	Up to 20 characters (alphanumeric characters, marks) On/Off		
	Clock Display	Time: 12H/24H, Date: 5 formats on the browser. Summer time (Auto / Manual)		
	Alarm Control	Reset		
	One Shot Capture	A still picture will be displayed on a newly opened window.		
	GUI/Setup Menu Language	English, French, Italian, Spanish, German, Russian, Chinese, Japanese		
	System Log	Up to 100 (Internal)		
<b>Network</b>	Supported OS <sup>1,2</sup>	Microsoft® Windows® 7 Microsoft® Windows Vista® Microsoft® Windows® XP Professional SP3		
	Supported Browser	Windows® Internet Explorer® 9.0 32 bit Windows® Internet Explorer® 8.0 32 bit Windows® Internet Explorer® 7.0 32 bit Internet Explorer® 6.0 SP3		
	Network IF	10Base-T / 100Base-TX, RJ-45 connector		
	Image Resolution	Picture (Camera) mode [4:3]	H.264: VGA (640x480)/QVGA (320x240), max. 30 fps JPEG: VGA (640x480)/QVGA (320x240), max. 30 fps	H.264: VGA (640x480)/QVGA (320x240), max. 25 fps JPEG: VGA (640x480)/QVGA (320x240), max. 25 fps
		Picture (Camera) mode [16:9]	H.264: 640x360/320x180, max. 30 fps JPEG: 640x360/320x180, max. 30 fps	H.264: 640x360/320x180, max. 25 fps JPEG: 640x360/320x180, max. 25 fps
		Picture (Camera) mode [D1]	H.264: D1 (720x480), max. 30 fps JPEG: D1 (720x480), max. 30 fps	H.264: D1 (720x576), max. 25 fps JPEG: D1 (720x576), max. 25 fps
	H.264 <sup>3</sup>	Transmission Mode	Constant bitrate / Framerate priority / Best effort	
		Frame Rate	1 / 3 / 5 / 7.5 / 10 / 15 / 20 / 30 fps	
		Bit Rate/Client	64 / 128 / 256 / 384 / 512 / 768 / 1,024 / 1,536 / 2,048 / 3,072 / 4,096 kbps	
		Image Quality	Low / Normal / Fine	
Refresh Interval		0.2 / 0.25 / 0.33 / 0.5 / 1 / 2 / 3 / 4 / 5 s		
JPEG	Image Quality	10 steps		
	Refresh Interval	0.1 fps ~ 30 fps (JPEG frame rate will be restricted when displaying both JPEG and H.264 images.)	0.08 fps ~ 25 fps (JPEG frame rate will be restricted when displaying both JPEG and H.264 images.)	
	Transmission Type	Pull / Push		
	Total Bit Rate	64 / 128 / 256 / 384 / 512 / 768 / 1,024 / 2,048 / 4,096 / 8,192 kbps / Unlimited		
	Supported Protocol	IPv6: TCP/IP, UDP/IP, HTTP, HTTPS, RTP, FTP, SMTP, DNS, NTP, SNMP, DHCPv6, MLD, ICMPv6 IPv4: TCP/IP, UDP/IP, HTTP, HTTPS, RTSP, RTP, RTP/RTCP, FTP, SMTP, DHCP, DNS, DDNS, NTP, SNMP, UPnP, IGMP, ICMP, ARP		
	FTP Client	Alarm image FTP transmission, FTP periodic image transmission <sup>4</sup>		
	No. of Simultaneous Users	Up to 14 users. (Depends on network conditions)		
	Cellular Phone Compatibility	JPEG image		
	Mobile Terminal Compatibility <sup>5</sup>	iPad, iPhone, iPod touch (iOS 4.2.1 or later), Android™ mobile terminals		
<b>Alarm</b>	Alarm Source	VMD, Command alarm, Video loss alarm		
	Alarm Actions	E-mail notification Indication on browser, FTP image transfer, Panasonic protocol output		
<b>Input/Output</b>	RS485 Port	1x RS485 (4 wire / 2 wire, Full/Half duplex). Open command conversion table for other manufacturers' PTZ camera)		
<b>General</b>	Safety/EMC Standard	UL (UL60950-1), FCC (Part15 ClassA), C-UL (CAN/CSA C22.2 No.60950-1), DOC (ICES003 ClassA)	CE (EN55022 ClassB, EN55024)	
	Power Source and Power Consumption	12 V DC*: 200 mA, PoE 48 V: 75 mA (Class 1 device) * For UL listed models, only connect 12 V DC Class 2 power supply.		
	Ambient Operating Temperature	-10 °C ~ +50 °C (14 °F ~ 122 °F) (During start-up: 0 °C to +50 °C (32 °F to 122 °F))		
	Ambient Operating Humidity	Less than 90 % (no condensation)		
	Dimensions	45 mm (W) x 29.5 mm (H) x 88 mm (D) {1-25/32 inches (W) x 1-5/32 inches (H) x 3-15/32 inches (D)} (excluding projections)		
	Mass (approx.)	Approx. 110 g (0.24 lbs)		
	Finish	Unit (resin part): PC resin, sail white Unit (metal part): Electrogalvanized steel sheet, sail white coating		

\*1 For further information about PC system requirements and precautions for when using Microsoft® Windows® 7, Microsoft® Windows Vista®, or Windows® Internet Explorer®, click "Manual" - "Open" from the supplied CD-ROM and refer to "Notes on Windows®/Internet Explorer® versions".  
\*2 When using IPv6 for communication, use Microsoft® Windows® 7 or Microsoft® Windows Vista®.  
\*3 Transmission for 2 streams can be individually set in the same compression method.  
\*4 Not available when "D1" is selected for "Picture (Camera) mode".  
\*5 For further information about compatible devices, refer to our website (<http://panasonic.net/pss/security/support/info.html>).

## Part Names and Functions

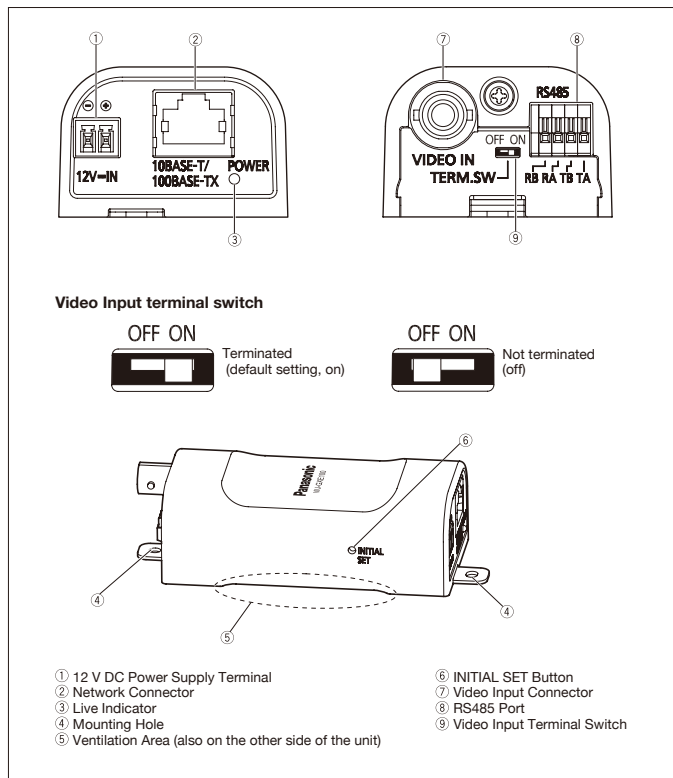

## Appearance

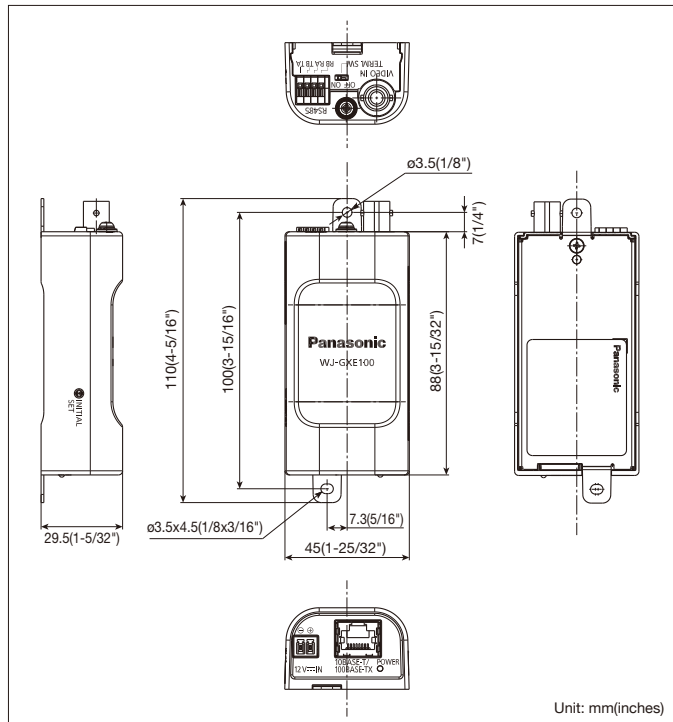

### Trademarks and registered trademarks

- Microsoft, and Windows are registered trademarks of Microsoft Corporation in the U.S. and other countries.
- iPad, iPhone and iPod touch are registered trademarks of Apple Inc.
- Android is a trademark of Google Inc.
- UniPhier is a registered trademark of Panasonic Corporation.
- "i-PRO SmartHD" logos are trademarks or registered trademarks of Panasonic Corporation.
- All other trademarks identified herein are the property of their respective owners.

### Important

- Safety Precaution: Carefully read the operating instructions and installation manual before using this product.
- Panasonic cannot be responsible for the performance of the network and/or other manufacturers' products used on the network.

- Masses and dimensions are approximate.
- Specifications are subject to change without notice.
- These products may be subject to export control regulations.

DISTRIBUTED BY:

# Panasonic

<http://panasonic.net/security/>

<http://www.facebook.com/PanasonicNetworkCamera>

Printed in Japan (2A-104AA)