

# NM-IP100\*

## H.264 Indoor Mini Dome IP Camera

- Built-in Video Content Analysis
- H.264 25 FPS@D1, 2-way Audio
- Video Compression: H.264, MPEG-4, MJPEG (Dual Stream)
- Deinterlacing on DSP
- Burnt-in Text, Video Motion Detection
- SDK for software integration



\*Manufactured by Y.H.Info

## Specifications

| Camera Module              |  |
|----------------------------|--|
| Image Sensor               | 1/4" VGA CMOS  |
| Effective Pixels           | 640 x 480  |
| Scanning System            | Progressive Scan   |
| Horizontal Resolution      | 550 TVL  |
| Minimum Illumination       | 3 Lux (colour), 0.1 Lux (DSS On)   |
| Lens                       | 3.6 mm F2.0, Board Type  |
| Day & Night                | S/W  |
| Function Key               | Not Available  |
| Video                      |  |
| Compression Format         | H.264, MPEG-4, MJPEG   |
| Number of Streams          | Dual Stream, Configurable  |
| Resolution                 | D1, CIF, QCIF  |
| Compression FPS            | 25 fps@D1  |
| Deinterlacing              | Yes (DSP)  |
| Motion Detection           | Yes (DSP)  |
| Burnt-in Text (Digital)    | Yes (DSP)  |
| Output                     | Not Available  |
| Audio                      |  |
| Input                      | 1 channel  |
| Output                     | 1 channel  |
| Compression Format         | G.711  |
| Function                   |  |
| Digital Input              | Not Available  |
| Digital Output             | Not Available  |
| RS-485                     | Not Available  |
| RS-232C                    | Not Available  |
| Network                    | 10 / 100 Base-T  |
| Protocol                   | TCP/IP, UDP/IP, HTTP, RTSP, RTCP, RTP/UDP, RTP/TCP, SNTP, mDNS, UPnP, SMTP, SOCK, IGMP, DHCP, FTP, DDNS, SSL v2/v3, IEEE 802.1X, SSH |
| USB 2.0                    | Not Available  |
| SD Memory                  | Not Available  |
| Electrical                 |  |
| Power Source               | 12V DC (DC Jack)   |
| Power over Ethernet        | Not Available  |
| Power Consumption (Approx) | 360 mA @ +12V  |
| Environmental              |  |
| Operating Temperature      | 0°C~50°C (32°F~122°F)  |
| Operating Humidity         | Up to 85% RH (Non-condensing)  |
| Mechanical                 |  |
| Material                   | Polycarbonate  |
| Colour                     | Black  |
| Dimension                  | Housing: 124(ø) x 101.5(H) mm, Dome: 100 (ø) mm  |
| Weight (Approx)            | 280 g  |

## Video Content Analytics (Included as Standard)

|                   |   |
|-------------------|---|
| High Performance  | Advanced Tracking Algorithm, Low False Alarm Rate |
| Easy to Use       | Intuitive Web Browser Interface                   |
| Detection Zones   | Multi-segment Polygons and Lines                  |
| On-screen Display | Real-time Display of Tracking Data and Events     |

## Video Content Analytics (Option)

|                     |  |
|---------------------|--|
| Detection Behaviour | Direction, Stopping, Loitering, Entering, Exiting, Appear, and Disappear Filters |
| 3D Behaviour        | Perspective Corrected Size and Speed Filters                                     |
| Statistics          | Counting Functions and Other Statistics  |
| Meta Data           | Binary XML Format  |

## Image Stabilization (Option)

|                          |                     |
|--------------------------|---------------------|
| Electronic Stabilization | Removes Camera Sway |
|--------------------------|---------------------|

Video Analytics included

## Dimension

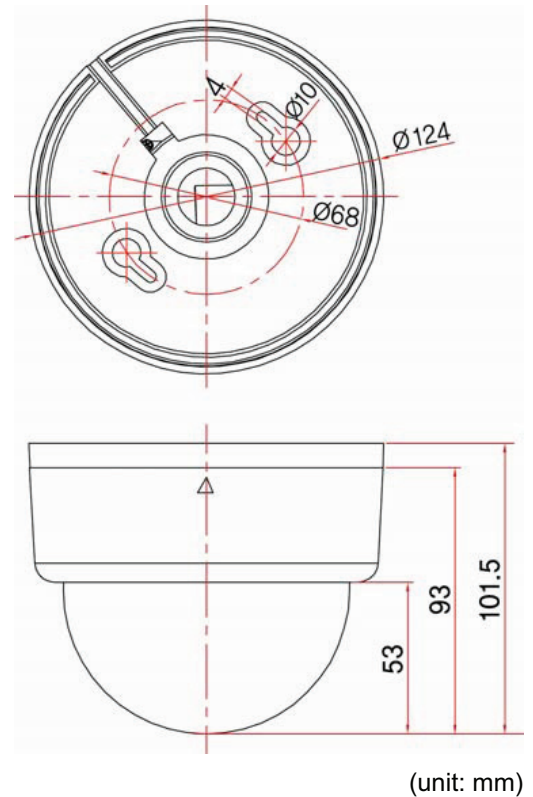

 **MITSUBISHI ELECTRIC EUROPE**

New publication, effective August 2010 Specifications subject to change without notice.