

Ikegami

GIVING NEW VALUE TO IMAGES

High Resolution Super Cube Colour CCD Camera 1/3"
with Day/Night Function

ICD-505P ACK (AC24V/DC12V)



The Ikegami ICD-505P ACK 1/3" High Resolution Colour Camera comes with an ultra compact body and manually switched (on/off) Automatic Chroma Killer (ACK) Day/Night function.

The camera features a high resolution chip set with high sensitivity and high picture quality.

The Chroma Killer circuit allows the camera to switch to a Monochrome output increasing the low light sensitivity even further.

With the added functions of Back Light Compensation, Automatic Electronic Shutter and Automatic Iris Control, this camera is ideally suited to General Surveillance applications that require a Cost Effective solution with the very highest levels of reliability and performance.

Features

- Ultra Compact Design (W 64 x H 64 x D 40.5 mm)
- Electronic Day/Night function (ACK)
- High Resolution (520 TV lines)
- High sensitivity 0.15 lux at F1.2 (ACK On)
- Automatic electronic shutter
- Back light compensation
- 2-way automatic iris control function
- Automatic white balance
- Switchable AC Line Lock/Internal Lock



High Resolution Super Cube Colour CCD Camera 1/3" with Day/Night Function

ICD-505P ACK (AC24V/DC12V)



■ Compact Palm Size Design



■ Specifications

Pickup Device	1/3" interline Transfer PAL: 752 (H) 582 (V)
Pixels	approx. 440,000 pixels
Scanning System	2:1 interlaced PAL
Sync System	INT/Line Lock (phase adjustment)
Frequency	15.625 KHz (H) 50 Hz (V) INT/LL
Video Output	VBS 1.0 Vp-p/75 Ω
Horizontal Resolution	520 TV lines
S/N Ratio	48 dB
Minimum Illumination	Colour mode 0.35 lux /F1.2 (30IRE) 0.7 lux/F1.2 (50IRE) B/W mode 0.15 lux /F1.2 (30IRE) 0.3 lux/F1.2 (50IRE)
Auto White Balance	ATW (Automatic tracking white balance)
Back Light Compensation	On/Off switchable
Automatic Electronic Shutter	On/Off switchable Range1:2000
Auto Gain Control	Provided (Fixed at ON)
Automatic Chrome Killer	Switchable
Auto Iris Function	Video/DC selectable (DC iris adjustable)
Lens Mount	CS-mount (C-mount adaptor can be used)
Flange Back Adjustment	Built-in
Camera Mount	1/4"-20UNC (each one for upper/bottom)
Dimensions	W 64 x H 64 x D 40.5 mm
Weight	300 g
Power Requirement	AC24 V ± 10% DC10.5 V to 15 V
Power Consumption	less than 4 W
Ambient Temperature	-10 °C to + 50 °C

■ Dimensions: mm

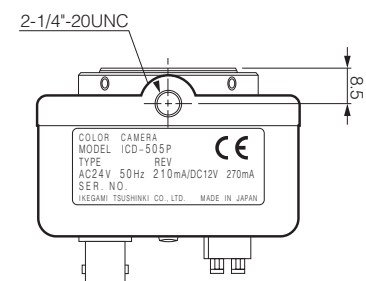
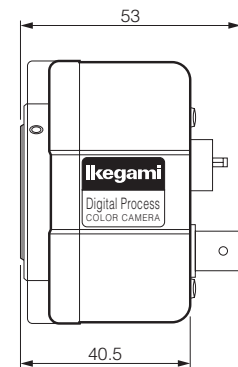
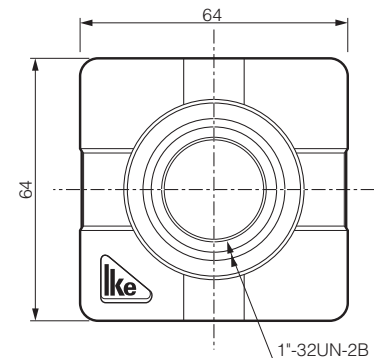

■ Rear Panel Design



ICD-505P ACK (AC24V/DC12V)

Design and specifications are subject to change without notice.

