

DS-6601/6602/6604HCI Encoder

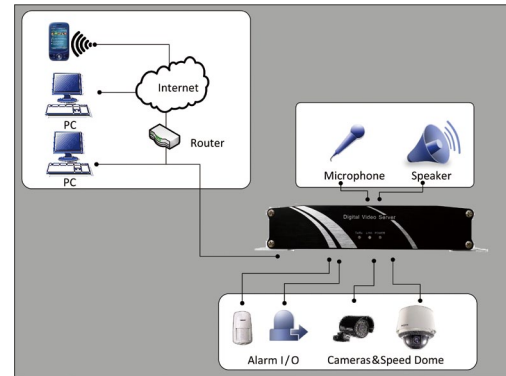

Key features

- H.264 video compression
- 4CIF resolution real-time recording
- Dual-stream
- Multiple PTZ protocols
- SADP(IP Finder), UDP, RTP and RTSP protocols

Rear Panel of DS-6602HCI



1. GND
2. DC12V
3. RS-485 serial interface
4. Alarm out
5. Alarm in
6. Reset
7. LAN (10M/100Mbps self-adaptive UTP Ethernet interface)
8. RS-232 serial interface
9. Video in
10. Audio in
11. Line in
12. Audio out

Specifications

	DS-6601HCI	DS-6602HCI	DS-6604HCI
Video/Audio input			
Video Compression	H.264		
Video input	1-ch, BNC (1.0 Vp-p, 75 Ω)	2-ch, BNC (1.0 Vp-p, 75 Ω)	4-ch, BNC (1.0 Vp-p, 75 Ω)
Audio Compression	OggVorbis		
Audio input	1-ch, BNC (2.0 Vp-p, 1 kΩ)	2-ch, BNC (2.0 Vp-p, 1 kΩ)	4-ch, BNC (2.0 Vp-p, 1 kΩ)
Two-way audio input	1-ch, 3.5 mm audio interface (2.0 Vp-p, 1 kΩ)		
Video/Audio output			
Audio output	1-ch, 3.5 mm audio interface (2.0 Vp-p, 600 Ω)		
Encoding resolution	4CIF / 2CIF / CIF / QCIF		
Frame rate	Main stream: 4CIF / 2CIF @ 12fps, CIF / QCIF @ 25 fps (P) / 30 fps(N) Sub stream: CIF / QCIF @ 25 fps (P) / 30 fps(N)		
Video bit rate	32 Kbps ~ 2048 Kbps, or user defined (Max. 3 Mbps)		
Audio bit rate	64 Kbps		
Dual-stream	Support		
Stream type	Video, Video & Audio		
External interface			
Network interface	1RJ-45 10 M / 100 Mbps self-adaptive UTP ethernet interface		
Serial interface	1 RS-485 interface (PTZ control), 1 RS-232 interface		
Alarm in	4		
Alarm out	2		
General			
Power supply	12 VDC		
Consumption	≤ 8 W (without HDD or DVD-R/W)		
Working temperature	-10 °C ~ +55 °C		
Working humidity	10% ~ 90%		
Dimensions (W × D × H)	200.5 × 136 × 42 mm		
Weight	≤ 2 kg		