

**Software Enhancement Modules (SEMs)** unlock advanced features within CyberAudit® software that provide specific functionality. Each SEM can be purchased individually, enabling CyberAudit customers to pay for only the features they need.

**Available SEMs include:**

**Enterprise Location Graphics Module (CAW-M01) [Enterprise 9.1 or newer]**

The Location Graphics Module opens a visual interface tool that allows CyberLocks and Communicators to be graphically “placed” on drawings, pictures, or maps (JPEG, PNG, or TIFF compatible). In particular, this module helps large and geographically spread-out CyberLock deployments to improve tracking and locating of locks and communicators.

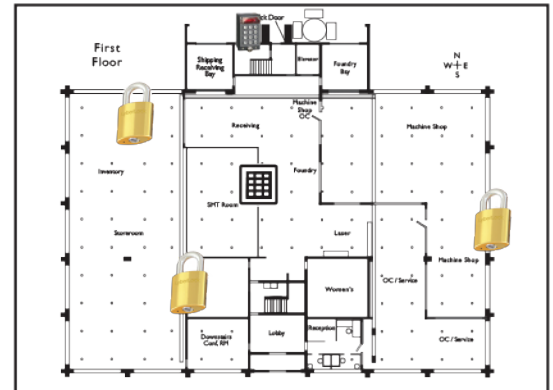

**Enterprise Door & I/O Support Module (CAW-M02) [Basic & Enterprise 9.1 or newer]**

The Door & I/O software Module adds software features required to manage all the functionality the door & I/O hardware Module brings to a Flex System installation. In addition to managing individual access rights to each other, Request-to-Exit (RTE) events are recorded, doors can be set to automatically unlock and relock at specified times, doors sensors are monitored, and alarms can be triggered if a door is forced or left open after a specified amount of time.



**Enterprise Key Security Enhancement Pack Module (CAW-M03) [Enterprise 9.1 or newer]**

The Key Security Enhancement Pack includes three security features. The first is an option that makes the first key of a multi-key operation the sole key able to open a CyberLock within a sixteen-second window. The second adds a Temporary Activation option that enables activating an expired CyberKey for five minutes by touching a selected CyberLock or CyberPoint® on legacy CyberKeys G2. A CyberKey can support temporary activation times between 2 min and 72 hours. The third feature provides an option to limit temporary activation and one-time use settings on legacy CyberKeys to an eight-second window.



**Enterprise Lock List Filtering (CAW-M04) [Enterprise 9.1 or newer]**

The Lock List Filtering Module enables limiting the number of locks loaded into Keys on a per communicator basis. This is needed when a legacy CyberKey requires individual permission to more than maximum 3300 lock capacity. With this enhancement, keys and missions may effectively be granted access to an unlimited number or individual Locks with each communicator in the system filtering the locks to selected tags. The Lock List Filtering Module is required to enable the improved 12,000 lock capacity in G2 CyberKeys.

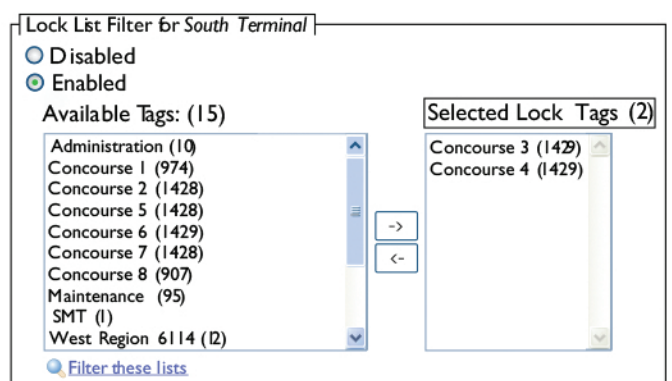

## Enterprise LDAP Authentication Module (CAW-M05) [Enterprise 9.1 or newer]

The LDAP Authentication Module enables basic LDAP authentication for selected administrator logins. When enabled, CyberAudit can optionally validate the administrator's login and password against the LDAP server, rather than locally from within CyberAudit Software. CyberAudit supports the LDAP method of sending the user name and password to the LDAP server via SSL on port 636. It does not support proxies or port forwarding to establish the LDAP connection. It is not designed for use with hosting systems.

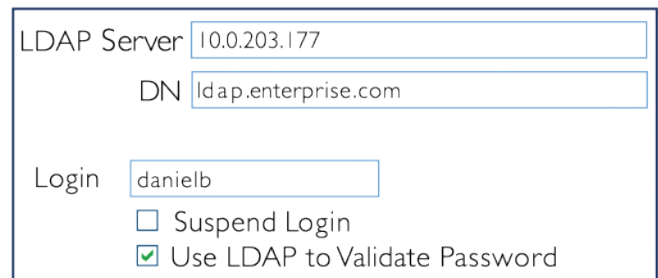

LDAP Server: 10.0.203.177  
 DN: ldap.enterprise.com  
 Login: danielb  
 Suspend Login  
 Use LDAP to Validate Password

## Advanced Door Features Module [Enterprise 9.1 or newer]

The Advanced Door Features Module adds 3 features for use with doors:

- A No PIN required schedule - During this time, a person with a PIN will not be required to enter their PIN to gain access to the door. This is useful in cases where a PIN is not required during normal business hours, but would be required at all of the other times.
- Keep Unlocked Calendar entries - Allows scheduling time windows during which a specified door will be held unlocked. CyberAudit-Web software adds the time frame of the calendar entry to the door's Keep Unlocked Calendar schedule in the week of the calendar entry. This feature is useful for facilities that schedule events on a calendar basis and want specified doors to be held unlocked for those events.
- A door monitor window - Display door activities in a scrolling window as they occur.

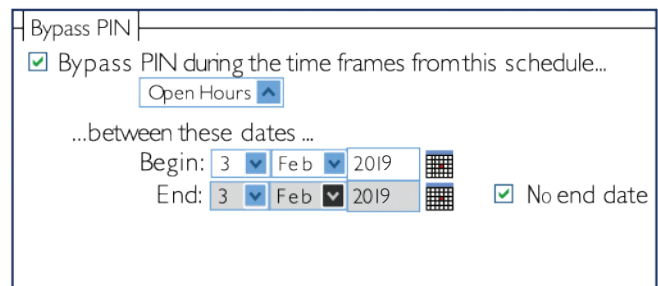

Bypass PIN  
 Bypass PIN during the time frames from this schedule...  
 Open Hours  
 ...between these dates ...  
 Begin: 3 Feb 2019  
 End: 3 Feb 2019  No end date

## Rolling Access Codes Module (CAW-M08) [Enterprise 9.1 or newer]

Automates the process of changing lock access codes for some or all CyberLock cylinders in a system. Access codes may be configured to change (roll) on a periodic basis. A "grace period" may be designated during which the lock will continue to honor the old access codes to complete the change for all affected locks.

## FlashLock Integration Module (CAW-M09) [Enterprise 9.1 or newer]

The FlashLock module adds complete support for adding FlashLocks and fobs to a CyberLock system. To grant access, FlashLocks may be added to an access list. Fobs may be assigned to people and given an expiration rule. Flash access may be distributed by email or text message. To take advantage of the text message Flash access distribution, U.S. resellers may purchase a texting package SWL-SMS-6K or subscribe to a 3rd party text message service. Outside of the United States and Canada use of the texting capability requires a subscription to a 3rd party text message service.



## Dynamic Tags (CAW-M10) [Enterprise 9.1 or newer]

Dynamic Tags enable granting access to CyberLocks based upon the values of user-defined fields in People, Lock, People tag, and Lock tag records. Unlike the traditional static tags, locks and People are automatically added to and removed from Dynamic Tags based upon whether their user-defined field values match the criteria of the tag.

Dynamic Tags can automatically grant or revoke access when the attributes of a person or lock change. For example, if access to a lock should only be permitted when a person's safety qualification has not expired, a person's access to the lock can be automatically revoked on the day the license expires.

