



Climax Wired Security System

A complete wired security system offered by Climax

The Climax wired security system is a comprehensive wired product line that provides sound protection suitable for a broad range of commercial application, offering another option besides Climax's wireless security solution.

The newly introduced VST-892-BUS is a hardwired PIR motion sensor camera capable of sending captured images to the Hybrid Panel upon movement detection. In addition, VST-892EX-BUS is suitable for outdoor application. Climax also launches TSP-BUS, a hardwired Touchscreen keypad that provides access to arm/disarm/home arm the system and intuitive operation of the security system.

Other products from the wired security system include Keypads, Motion Sensor Cameras, Motion Detectors, Sirens, Bell Box, Door/Window Contact and Expansion Modules. Through BUS connection, the wired devices allow connection of several devices at once for enhanced flexibility and redundancy.



Wired System Topology

Hybrid Security Alarm System

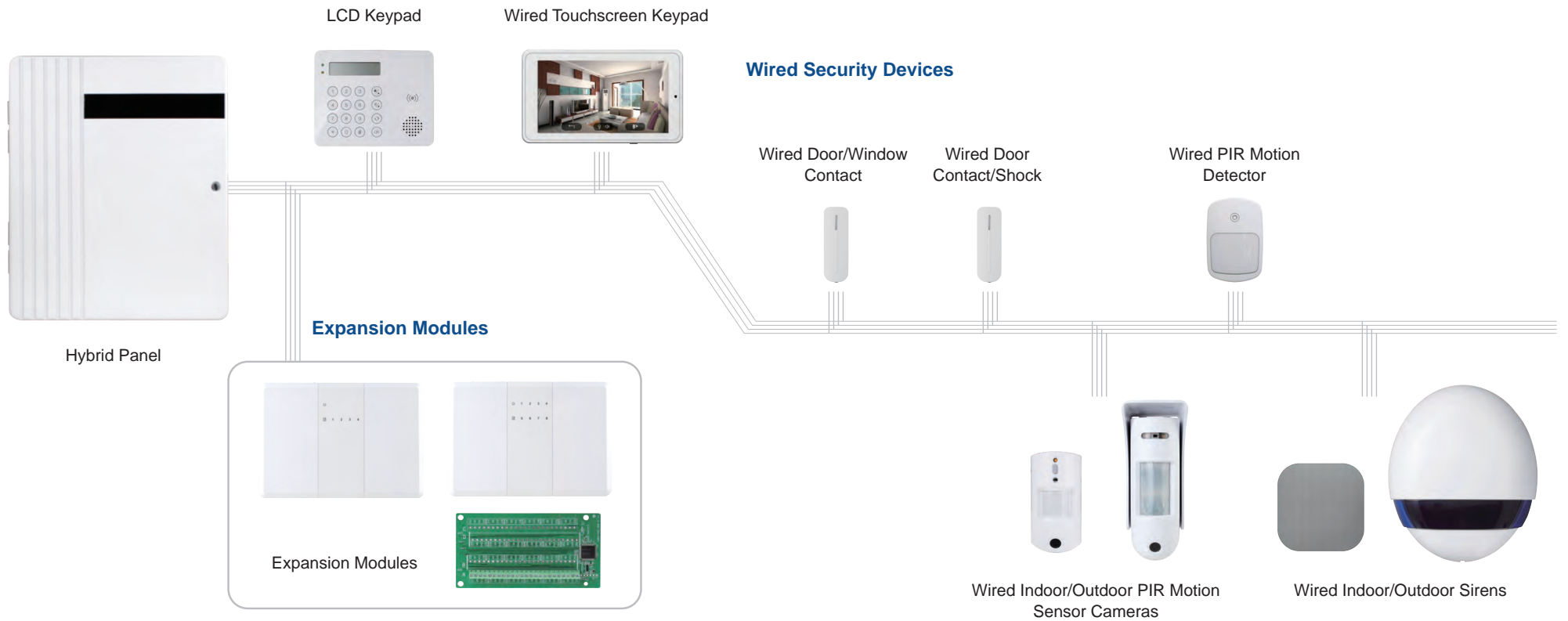

Control Panel

Hybrid Security Alarm System

Hybrid Panel



Hybrid Security System

- A wired and wireless IP-based smart home security gateway with LTE capability
- Wired & wireless zones: 80 per areas, 640 in total
- 8 Areas and 16 on-board zones available
- Number of BUS connected devices: 128 (Maximum of 4 KPT-35(N)-BUS models)
- Smart Automation that incorporates ZigBee/Z-Wave devices
- World-leading 2-Km RF Range that delivers RF communication range of 2km
- 24-Hour Emergency Monitoring by incorporating emergency security devices
- Scalable System that integrates wired zone expansion modules and devices
- Visual Verification and Real-time Visual Monitoring by incorporating cameras
- Remote and Mobile Control via Vesta Home 5 web portal/App
- Power: 100-240VA, 50/60 Hz
- Total current consumption of wired zones, keypad and auxiliary output: 13.5V (Typical)

Wired Security Sensors

Wired Keypad

KPT-35(N)-BUS Series



Wired Keypad

- Wired combo keypad
- LCD displays
- Wall mount tamper
- Regular supervision signals to check system integrity
- Dual key function to trigger panic, fire or medical alarms
- Input Voltage from Hybrid Panel: 13.5V DC
- Current Consumption: 24.4 mA (standby); 77.6 mA (maximal)

TSP-BUS



Touchscreen Keypad

- 7" high resolution color graphic touchscreen
- Panel status and event revision
- Automation control
- Video Verification of IP cameras and video phones
- Built-in microphone and speaker
- OTA firmware update capability
- Input Voltage from Hybrid Panel: 13.5V DC
- Current Consumption: 10 mA (standby); 411 mA (maximal)

Motion Sensor Camera

VST-892-BUS Series



Hardwired PIR Motion Sensor Camera

- Detection Range: 12 meters
- Horizontal Angle: 90°
- Installation height: 2.3-2.5m
- Pet immunity enabled / disabled by remote control setting
- Anti-masking feature
- Night illumination capability
- Tamper protection to prevent unauthorized sabotage
- EN Compliance
- Input Voltage from Hybrid Panel: 13.5V DC
- Current Consumption: 0.87 mA (standby); 89.7 mA (maximal)

VST-892EX-BUS Series



Outdoor Hardwired PIR Motion Sensor Camera

- Detection Range: 10 meters
- Horizontal Angle: 90°
- Installation height: 2.3-2.5m
- Pet immunity configuration via jumper switch
- Anti-masking feature
- Night illumination capability
- IPX6 for outdoor usage
- Tamper protection to prevent unauthorized sabotage
- EN Compliance
- Input Voltage from Hybrid Panel: 13.5V DC
- Current Consumption: 0.83 mA (standby); 141.5 mA (maximal)

Motion Detector

IR-35-BUS



PIR Motion Detector

- Lens support range of 15 meters and angle up to 130°
- Mounting height: 2.3-2.5 m
- Turn on/off pet immunity by setting a jumper
- Tamper protection against sabotage
- Temperature compensated sensitivity control
- Input Voltage from Hybrid Panel: 13.5V DC
- Current Consumption: 2.37 mA (standby); 14.4 mA (maximal)

Siren

SR-35-BUS



Indoor Siren

- Siren output level is 95dB at 1 meter
- Capable of remote programming
- Programmable siren duration of 3/5/10 minutes
- Cover tamper protection prevents unauthorized removal and sabotage
- Regular supervision signals to check system integrity
- Compliant with CE requirement
- Input Voltage from Hybrid Panel: 13.5V DC
- Current Consumption: 0.84 mA (standby); 39.3 mA (maximal)

Bell Box

BX-32-BUS



Outdoor Bell Box

- Siren output level is 104dB at 1 meter
- Programmable siren duration of 3/5/10 minutes
- Cover tamper protection prevents unauthorized removal and sabotage
- IPX5 waterproof and UV resistant housing
- EN Compliance
- Input Voltage from Hybrid Panel: 13.5V DC
- Current Consumption: 0.88 mA (standby); 54.8 mA (maximal)

Door/Window Contact

DC-23-BUS Series



Door/Window Contact

- Extension terminals for connection to wired devices
- Powerful magnet allows for an overall side-to-side gap distance of 28mm
- Enables home automation to turn on/off appliances
- Doubles as an universal transmitter
- Tamper protection to prevent unauthorized removal
- EN Compliance
- Input Voltage from Hybrid Panel: 13.5V DC
- Current Consumption: 0.64 mA (standby); 11.2 mA (maximal)

DCSV-29-BUS



Door Contact / Shock Sensor

- Three adjustable sensitivity threshold levels (high, medium and low)
- Tamper switches for sabotage detection
- Enable security and home automation systems scheduling, scene creation to turn on / off appliances accordingly
- EN Compliance
- Input Voltage from Hybrid Panel: 13.5V DC
- Current Consumption: 0.79 mA (standby); 8 mA (maximal)

Expansion Modules

Expansion Module

WEZC-8 Series



8 wired zone expansion module

- Expansion of additional wired zones of 8
- Dual wall-mount & front cover tamper protection
- Plastic housing
- Rechargeable backup battery (for WEZC-8B only)
- EN50131 Grade 3, Class II certified
- Power Source: 1600 mAh Ni-MH battery pack; Battery Life: 35 hours* (WEZC-8B model only)
- Input Voltage from Hybrid Panel: 13.5V DC
- Current Consumption: 6 mA (standby); 95mA (maximal)

WEZ-12/24/36/48-BUS

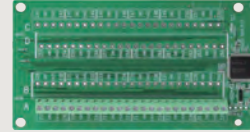

8 wired zone expansion module

- Expansion of additional wired zones of 12, 24, 36, 48
- EN50131 Grade 3, Class II certified
- Input Voltage from Hybrid Panel: 13.5V DC
- Current Consumption: 6 mA (standby); 31mA (maximal)

WEPC-1 Series



Programmable Output Expansion Module

- Expansion of additional 4 programmable outputs
- Wall-mount & front cover tamper protection
- Plastic housing
- Rechargeable backup battery (for WEPC-1B only)
- Power Source: 1600 mAh Ni-MH battery pack; Battery Life: 7 ~ 23 hours* (WEPC-1B only)
- Input Voltage from Hybrid Panel: 13.5V DC
- Current Consumption: 9 mA (standby); 240 mA (maximal)



Climax Technology Co., Ltd.
Website: <http://www.climax.com.tw>
Email: sales@climax.com.tw

Copyright© 2022 Climax Technology Co., Ltd. All Rights Reserved.
DEC. 22, 2022