

# FaceDeep 5

AI Based Smart Face Recognition Terminal



Liveness Face  
Detection

**AI**

AI Deep Learning  
Architecture



IP65



Mask  
Detection

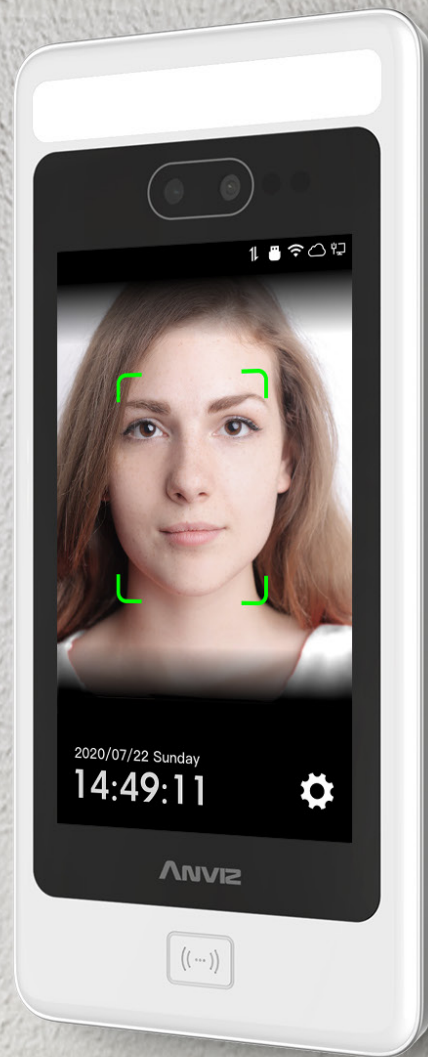

FaceDeep 5 is the new AI-based face recognition terminal equipped with a dual-core based Linux based CPU and the latest BioNANO<sup>®</sup> deep learning algorithm. FaceDeep 5 terminal supports up to 100,000 dynamic face database and can reach an under 100ms new face learning and face recognition time by 1:100,000. FaceDeep5 terminal is equipped with a 5" IPS full angles TFT-LCD screen. FaceDeep 5 terminal can realize true liveness detection by multispectral imaging technology.

# FaceDeep 5

AI Based Smart Face Recognition Terminal

## Features



### 1GHz Linux Based Processor

The new Linux based 1GHz processor ensures the 1:50,000 comparison time less than 0.3 second.



### Wi-Fi Flexible Communication

Wi-Fi function can realize stable wireless communication and realize flexible installation of equipment.



### Liveness Face Detection

Live face recognition based on infrared and visible light.



### Wide Angle Camera

The ultra-wide-angle camera enables fast face recognition.



### IPS Full Screen

The colorful IPS screen ensures the best interaction and user experiences and can also provide clear notifications to the users.



### Web Server

The web server ensures the easily quick connection and self management of the device.



### Cloud Application

The web based cloud application let you access to the device by any mobile terminal from anytime and anywhere.

## Key Specifications

User	100,000
Card	100,000
Record	500,000
Communication	RS485, TCP/IP, RS232, Wi-Fi
Identification Mode	Face, Password, RFID Card
Face Identification	<100ms, Max. 2m(78.7inch)
Card Reading Distance	125KHz(1~5cm), 13.56MHz(< 2cm) for Standard CR80 Card
Web Server	Support
CPU	Dual Core Linux Based 1GHz CPU with Enhanced AI Computing Power
RFID Card	Standard EM, Optional Mifare
Working Temperature	-30 °C (-22 °F)- 60 °C (140 °F)
Humidity	20% to 90%
Power	DC12V 3A
Protection	IP65
Angle Range	74.38°(Vision), 67.57°(Infrared)

## System Configurations

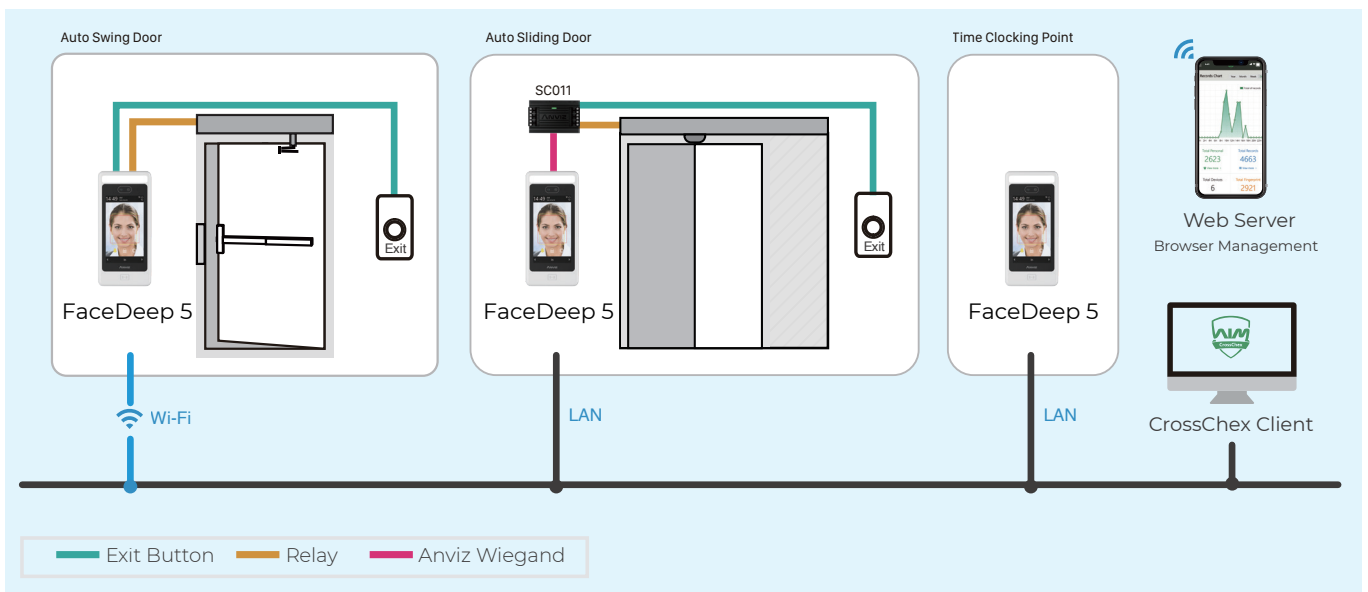

### Anviz Global Inc.

41656 Christy Street Fremont, Fremont, CA, 94538

Tel: 1-510-573-6552 | Toll-free: 1-855-268-4948 | [sales@anziv.com](mailto:sales@anziv.com) | [www.anziv.com](http://www.anziv.com)

©2020 Anviz Global Inc. Anviz and identifying product names and numbers herein are registered trademarks of Anviz Global Inc. All non-Anviz brands and product names are trademarks or registered trademarks of their respective companies. Product appearance, build status and/or specifications are subject to change without notice.